



# Center Console Panel/Center Armrest

## Replacement

SRS wire harnesses are routed near the center console panel and center armrest.

### CAUTION:

- All SRS wiring harnesses are covered with yellow outer insulation.
- Before disconnecting any part of the SRS wire harness, install the short connectors (see page 23-371).
- Replace the entire affected SRS harness assembly if it has an open circuit or damaged wiring.

### NOTE:

- Take care not to scratch the dashboard and related parts.
- Do not drop the screws inside the center console.

**CAUTION:** When prying with a flat tip screwdriver, wrap it with protective tape to prevent damage.

Disassemble in the numbered sequence.

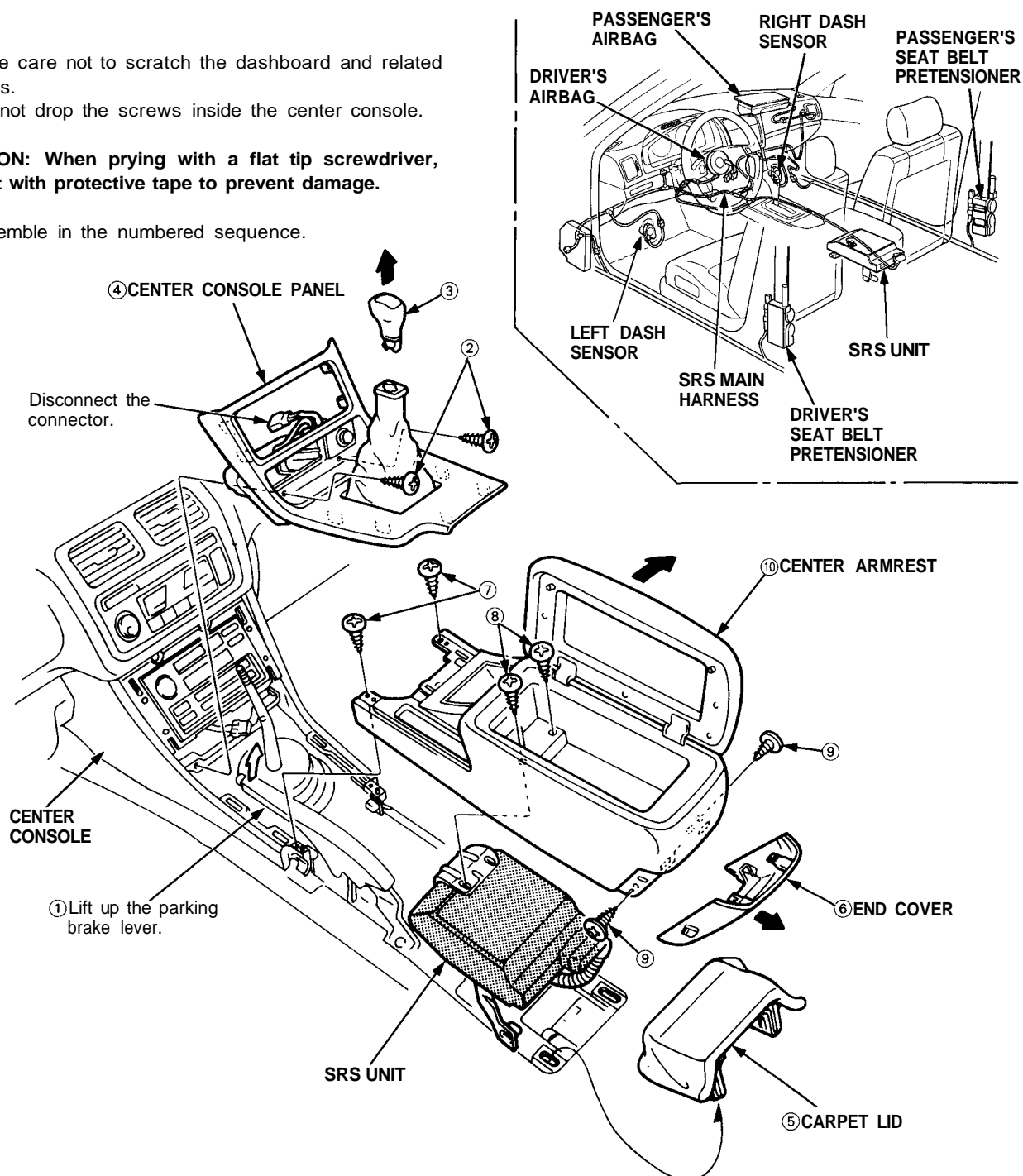

Installation is the reverse of the removal procedure.